

TD-QC3141R-50

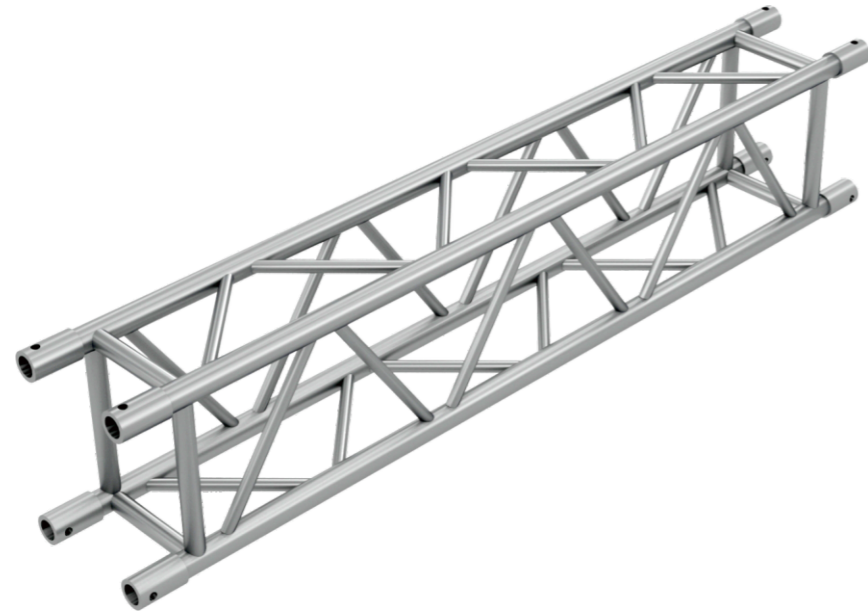

Top view

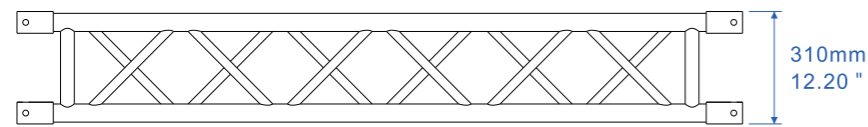

Side view

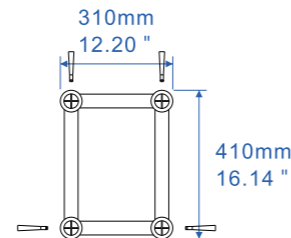
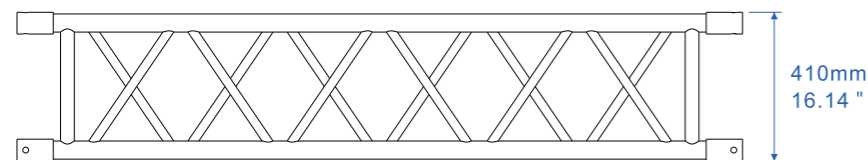

Dimensions TD-QC3141R-50

| Shape | Rectangular | Rectangular |
|---------------------|----------------------|---------------------------|
| Material | EN AW 6082 T6 | EN AW 6082 T6 |
| Main Tubes (chords) | 50 x 3 mm Cross Pipe | 1.97 x 0.12 in Cross Pipe |
| Braces | 25 x 2 mm | 0.98 x 0.08 in |
| Weight | ≈9.0kg/m | ≈6.05lbs/ft |

1 inch = 25.4 mm 1 m = 3.28 ft 1 lbs = 0.453kg

TD-QC3141R-50 ALLOWABLE LOADING

| SPAN | Uniformly Distributed Load | | DEFLECTION | | Centre Point Load | | DEFLECTION | | single load third points | | single load fourth points | | single load fifth points | | SPAN | |
|------|----------------------------|--------|------------|-------|-------------------|--------|------------|------|--------------------------|--------|---------------------------|--------|--------------------------|--------|--------|-------|
| | | | | | kg | lbs | mm | inch | kg | lbs | kg | lbs | kg | lbs | | |
| 3 | 9.8 | 2112.3 | 1421.6 | 1.9 | 0.075 | 3168.5 | 6994.5 | 1.5 | 0.059 | 2376.4 | 5245.9 | 1584.2 | 3497.1 | 1267.4 | 2797.8 | 27.0 |
| 4 | 13.1 | 1188.2 | 799.7 | 3.4 | 0.134 | 2376.4 | 5245.9 | 2.7 | 0.106 | 1782.3 | 3934.4 | 1188.2 | 2623.0 | 950.5 | 2098.2 | 36.0 |
| 5 | 16.4 | 760.4 | 511.8 | 5.3 | 0.209 | 1901.1 | 4196.7 | 4.2 | 0.165 | 1425.8 | 3147.5 | 950.5 | 2098.2 | 760.4 | 1678.6 | 45.0 |
| 6 | 19.7 | 528.1 | 355.4 | 7.6 | 0.299 | 1584.2 | 3497.1 | 6.1 | 0.240 | 1188.2 | 2623.0 | 792.1 | 1748.6 | 633.7 | 1398.9 | 54.0 |
| 7 | 23.0 | 388.0 | 261.1 | 10.3 | 0.406 | 1357.9 | 2997.6 | 8.3 | 0.327 | 1018.4 | 2248.1 | 679.0 | 1498.9 | 543.2 | 1199.1 | 63.0 |
| 8 | 26.2 | 297.0 | 199.9 | 13.5 | 0.531 | 1188.2 | 2623.0 | 10.8 | 0.425 | 891.1 | 1967.1 | 594.1 | 1311.5 | 475.3 | 1049.2 | 72.0 |
| 9 | 29.5 | 234.7 | 158.0 | 17.1 | 0.673 | 1056.2 | 2331.6 | 13.7 | 0.539 | 792.1 | 1748.6 | 528.1 | 1165.8 | 422.5 | 932.7 | 81.0 |
| 10 | 32.8 | 190.1 | 127.9 | 21.1 | 0.831 | 950.5 | 2098.2 | 16.9 | 0.665 | 712.9 | 1573.7 | 475.3 | 1049.2 | 380.2 | 839.3 | 90.0 |
| 11 | 36.1 | 157.1 | 105.7 | 25.5 | 1.004 | 864.1 | 1907.5 | 20.4 | 0.803 | 648.1 | 1430.7 | 432.1 | 953.9 | 345.7 | 763.1 | 99.0 |
| 12 | 39.4 | 132.0 | 88.8 | 30.4 | 1.197 | 792.1 | 1748.6 | 24.3 | 0.957 | 594.1 | 1311.5 | 396.1 | 874.4 | 316.8 | 699.3 | 108.0 |
| 13 | 42.6 | 112.5 | 75.7 | 35.6 | 1.402 | 731.2 | 1614.1 | 28.5 | 1.122 | 548.4 | 1210.6 | 365.6 | 807.1 | 292.5 | 645.7 | 117.0 |
| 14 | 45.9 | 97.0 | 65.3 | 41.3 | 1.626 | 679.0 | 1498.9 | 33.1 | 1.303 | 509.2 | 1124.1 | 339.5 | 749.4 | 271.6 | 599.6 | 126.0 |
| 15 | 49.2 | 84.5 | 56.9 | 47.4 | 1.866 | 633.7 | 1398.9 | 37.9 | 1.492 | 475.3 | 1049.2 | 316.8 | 699.3 | 253.5 | 559.6 | 135.0 |
| 16 | 52.5 | 74.3 | 50.0 | 54.0 | 2.126 | 594.1 | 1311.5 | 43.2 | 1.701 | 445.6 | 983.7 | 297.0 | 655.6 | 237.6 | 524.5 | 144.0 |
| 17 | 55.8 | 65.8 | 44.3 | 60.9 | 2.398 | 559.1 | 1234.2 | 48.7 | 1.917 | 419.4 | 925.8 | 279.6 | 617.2 | 223.7 | 493.8 | 153.0 |
| 18 | 59.0 | 58.7 | 39.5 | 68.3 | 2.689 | 528.1 | 1165.8 | 54.6 | 2.150 | 396.1 | 874.4 | 264.0 | 582.8 | 211.2 | 466.2 | 162.0 |
| 19 | 62.3 | 52.7 | 35.5 | 76.1 | 2.996 | 500.3 | 1104.4 | 60.9 | 2.398 | 375.2 | 828.3 | 250.1 | 552.1 | 200.1 | 441.7 | 171.0 |
| 20 | 65.6 | 47.5 | 32.0 | 84.3 | 3.319 | 475.3 | 1049.2 | 67.5 | 2.657 | 356.5 | 787.0 | 237.6 | 524.5 | 190.1 | 419.6 | 180.0 |
| 21 | 68.9 | 43.1 | 29.0 | 93.0 | 3.661 | 452.6 | 999.1 | 74.4 | 2.929 | 339.5 | 749.4 | 226.3 | 499.6 | 181.1 | 399.8 | 189.0 |
| 22 | 72.2 | 39.3 | 26.4 | 102.0 | 4.016 | 432.1 | 953.9 | 81.6 | 3.213 | 324.1 | 715.5 | 216.0 | 476.8 | 172.8 | 381.5 | 198.0 |
| 23 | 75.4 | 35.9 | 24.2 | 111.5 | 4.390 | 413.3 | 912.4 | 89.2 | 3.512 | 310.0 | 684.3 | 206.6 | 456.1 | 165.3 | 364.9 | 207.0 |
| 24 | 78.7 | 33.0 | 22.2 | 121.4 | 4.780 | 396.1 | 874.4 | 97.1 | 3.823 | 297.0 | 655.6 | 198.0 | 437.1 | 158.4 | 349.7 | 216.0 |

1 inch = 25.4 mm 1 m = 3.28 ft 1 lbs = 0.453kg

- Loading figures only valid for static loads and spans with two supporting points.
- Spans must be supported at each end.
- If dynamic loads or wind loads are involved, or more supporting points are applied, contact Trinity Customer Service for details.
- Loading figures are based on BS 7905-2/ANSI E1.2-2006/CWA 15902-2, GB/T5237. The loading data should multiply 0.8 for Safety factor consideration.
- The self-weight of the trusses has already been taken into account.
- Suitable for trusses with design height of 410mm, Main tubing Ø50 * 3mm with cross insert, brace tubing Ø25 * 2mm.