

# Quick Mount Series

## TD-QC46S-50

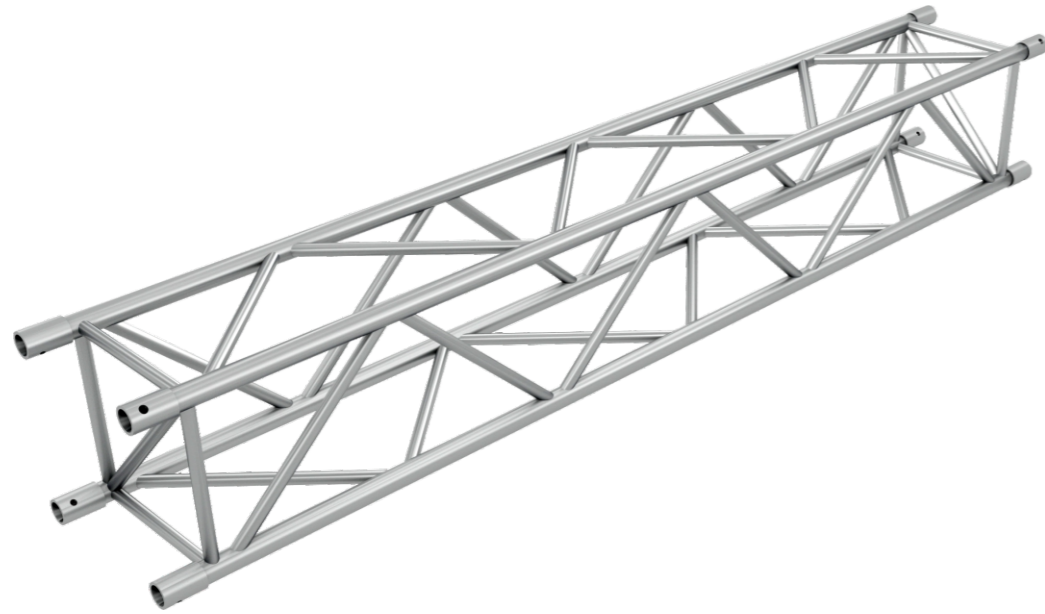

Top view

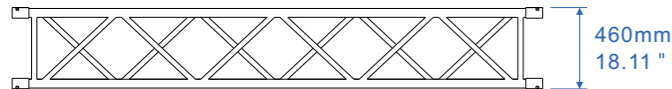

Side view

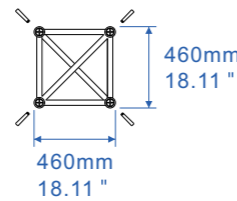
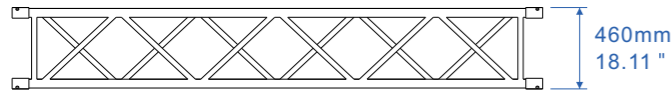

### Dimensions TD-QC46S-50

Shape	Square	Square
Material	EN AW 6082 T6	EN AW 6082 T6
Main Tubes (chords)	50 x 3mm	2.36 x 0.12in
Braces	30 x 3mm	1.19 x 0.12in
Weight	≈ 9.36kg/m	≈ 6.30lbs/ft

1 inch = 25.4 mm    1 m = 3.28 ft    1 lbs = 0.453kg

### TD-QC46S-50 ALLOWABLE LOADING

SPAN		Uniformly Distributed Load		DEFLECTION		Centre Point Load		DEFLECTION		single load third points		single load fourth points		single load fifth points		SPAN
m	ft	kg/m	lbs/ft	mm	inch	kg	lbs	mm	inch	kg	lbs	kg	lbs	kg	lbs	total weight
4	13.1	2125	1430.2	2.5	0.098	7110	15695.4	4.2	0.165	5265	11622.5	3525	7781.5	2950	6512.1	37.4
8	26.2	950	639.4	13.5	0.531	3865	8532.0	15.2	0.598	3200	7064.0	2285	5044.2	1685	3719.7	74.8
12	39.4	310	208.6	19.2	0.756	2385	5264.9	23.6	0.929	1785	3940.4	1380	3046.4	1020	2251.7	112.2
16	52.5	192	129.2	28.3	1.114	1565	3454.8	30.2	1.189	1285	2836.6	954	2106.0	772	1704.2	149.6
20	65.6	78	52.5	38.2	1.504	940	2075.1	40.3	1.587	765	1688.7	620	1368.7	465	1026.5	187.0
24	78.7	43	28.9	56.3	2.217	600	1324.5	58.5	2.303	495	1092.7	390	860.9	285	629.1	224.4

1 inch = 25.4 mm    1 m = 3.28 ft    1 lbs = 0.453kg

- Loading figures only valid for static loads and spans with two supporting points.
- Spans must be supported at each end.
- If dynamic loads or wind loads are involved, or more supporting points are applied, contact Trinity Customer Service for details.
- Loading figures are based on BS 7905-2/ANSI E1.2-2006/CWA 15902-2, GB/T5237. The loading data should multiply 0.8 for Safety factor consideration.
- The self-weight of the trusses has already been taken into account.
- Suitable for trusses with design height of 460mm, Main tubing Ø50 \* 3.0mm with cross insert, brace tubing Ø30 \* 3mm.